

CLASS 10000 HD SERIES 18 SC

EXTENDED HUB, RH ROTATION

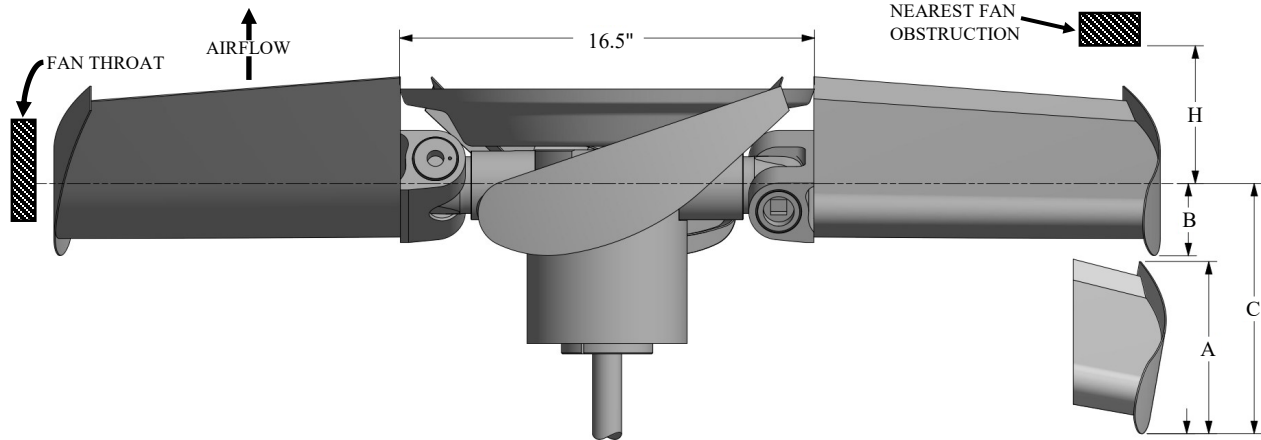

A = BLADE TIP THICKNESS @ 19° BLADE ANGLE
 B = RUNNING POSITION OF BLADES
 C = MAXIMUM DROOP POSITION OF BLADES
 D = MINIMUM OBSTACLE CLEARANCE AT INLET
 F = CENTERLINE OF FAN TO BASE OF BUSHING
 G = BUSHING OVERALL HEIGHT
 H = MINIMUM OBSTACLE CLEARANCE AT OUTLET
 I = NOMINAL MECHANICAL HUB DIAMETER
 L = MAXIMUM BUSHING TORQUE FT. LBS.
 # = WITH S.A.E. STANDARD SQUARE KEYWAY
 * = WITH SHALLOW KEYWAY IN BUSHING
 O = MAX METRIC BORE WITH STANDARD KEYWAY

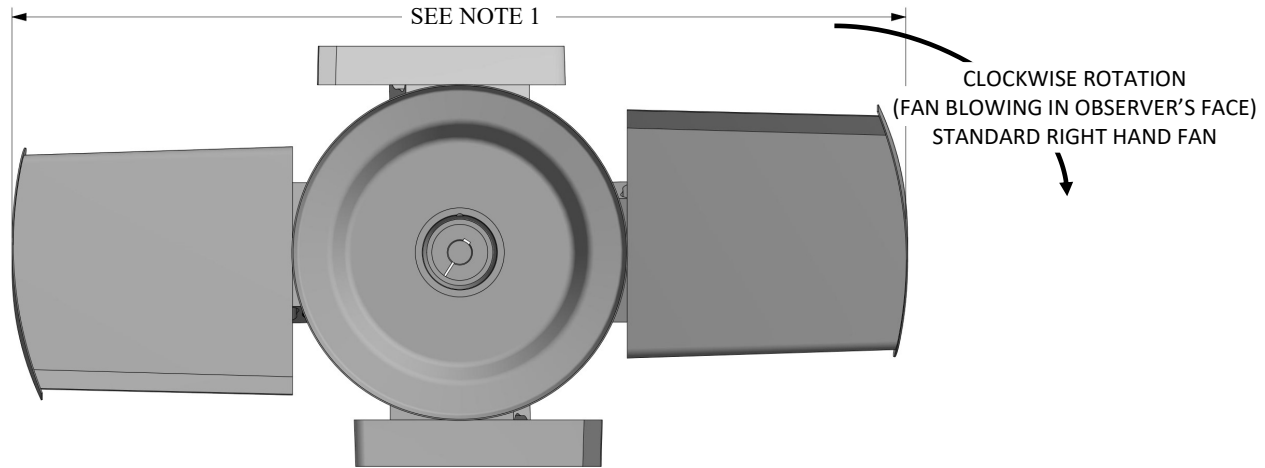
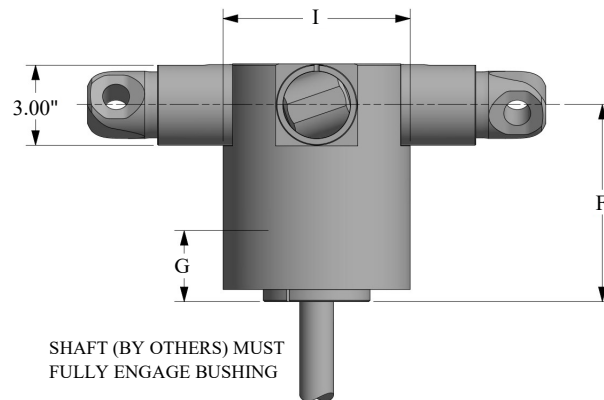

NOTE 1:

MAXIMUM FAN DIAMETER EQUALS NOMINAL FAN DIAMETER. ADJUSTMENT OF -1.0" ON DIAMETER POSSIBLE AT INSTALLATION

*BLADES WITH ATEX TIPS HAVE ADJUSTMENT OF -0.5" ON DIAMETER

WITH FAN OPERATING AT 12000 FT/MINUTE BLADE TIP SPEED					
DIA	A	PERCENT BLADE LOADING		C	D
		100%	75%		
		B			H
3'	5.2"	1.1"	0.8"	3.1"	2.0"
4'	4.8"	1.4"	1.0"	3.4"	2.0"
5'	4.4"	1.7"	1.3"	3.7"	2.0"
6'	4.0"	2.0"	1.5"	4.0"	2.0"

MAX BLADES	BUSHING TYPE	MAX # BORE	MAX * BORE	MAX o BORE	I	F	G	L
6	U	2.750"	2.938"	75	7"	5.5", 8.0", 12"	2.7"	4000