

NOTE 1:
 MAXIMUM FAN DIAMETER (BLADES HORIZONTAL - AS SHIPPED) EQUALS NOMINAL FAN DIAMETER. ADJUSTMENT OF ±1.5 INCHES* POSSIBLE AT INSTALLATION

*BLADES WITH ATEX TIPS HAVE ADJUSTMENT OF -1.0" & +2.0 ON DIAMETER"

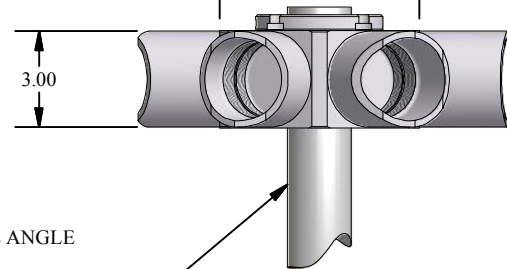
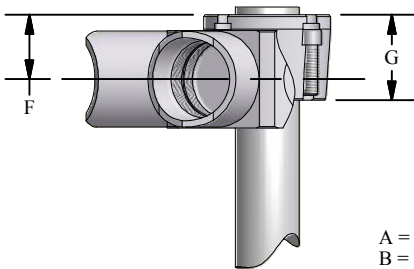
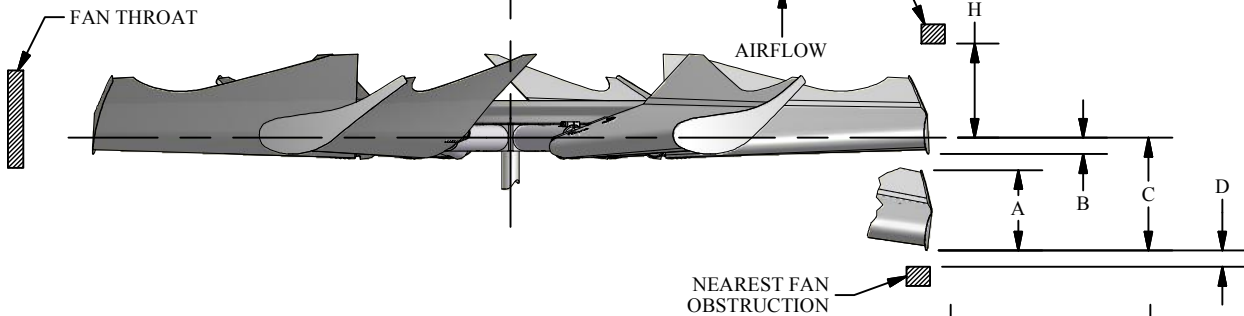

- A = BLADE TIP THICKNESS @ 19° BLADE ANGLE
- B = RUNNING POSITION OF BLADES
- C = MAXIMUM DROOP POSITION OF BLADES
- D = MINIMUM OBSTACLE CLEARANCE AT INLET
- F = CENTERLINE OF FAN TO BASE OF BUSHING
- G = BUSHING OVERALL HEIGHT
- H = MINIMUM OBSTACLE CLEARANCE AT OUTLET
- I = NOMINAL MECHANICAL HUB DIAMETER
- L = MAX. BUSHING TORQUE FT. LBS.
- # = WITH S.A.E. STANDARD SQUARE KEYWAY
- * = WITH SHALLOW KEYWAY IN BUSHING
- ° = MAX METRIC BORE WITH STANDARD KEYWAY

NOTE:
 BUSHING AND/OR AIR SEAL CAN BE INSTALLED ON INLET OR OUTLET SIDE OF FAN

WITH FAN OPERATING AT 12000 FT: MINUTE BLADE TIP SPEED
 PERCENT BLADE LOADING

DIA	100%		75%		C	D	H
	A	B	B	C			
6'	7.5"	4.5"	4.4"	4.9"	2.0"	14.0"	
7'	7.5"	5.0"	4.8"	5.7"	2.0"	14.0"	
8'	7.5"	5.6"	5.2"	6.6"	2.0"	14.0"	
9'	7.5"	6.4"	5.8"	7.8"	2.0"	14.0"	
10'	7.5"	7.3"	6.5"	9.2"	2.0"	14.0"	
11'	7.5"	8.3"	7.3"	10.8"	2.0"	14.0"	
12'	7.5"	9.5"	8.2"	12.7"	2.0"	14.0"	

MAX BLADES	BUSHING TYPE	MAX # BORE	MAX * BORE	MAX ° BORE	I	F	G	L
6	U	2.750"	2.938"	75	7"	2.0"	2.7"	4000
8	U	2.750"	2.938"	75	9"	2.0"	2.7"	4000
8	W	3.750"	4.000"	100	9"	2.2"	2.8"	7300
8	X	3.750"	4.000"	100	9"	2.2"	4.0"	9800



SERIES 36 STANDARD HUB EXTENDED CHORD HD FAN-RIGHT HAND ROTATION